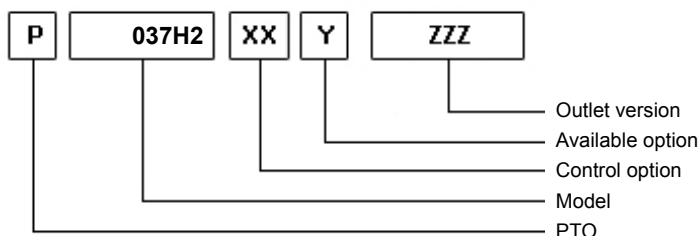
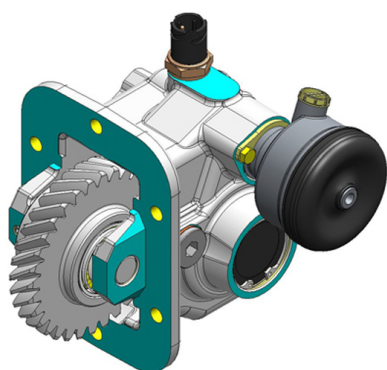

POSSIBLE SOLUTIONS

24/05/2022

TEC. SPECIFICATIONS

Status	In production	Revision	0
Torque (NM)	250	Replaces	
Int. Ratio	1,684	Replaced by	
Teeth number	32		

CONTROL TYPE HYDROCAR
 Electric
 Hydraulic
 Mechanic
 Fixed engagement
 Pneumatic
 Vacuum system

CONTROL VERSIONS (XX)

Type	P17A6	Description
E (Electric)	7	#Com. El.KES5E 12V ZAMA
E (Electric)	8	#Com. El.KES5E 24V ZAMA
E (Electric)	9	#Com. El. ECO150 12V
M (Mechanic)	1	#Comando Meccanico per TXZ
P (Pneumatic)	1	#Comando Pneumat. 1/8"GAS

AVAILABLE OPTIONS (Y)

P17A6	Description	Lubr. Kit	Switch Kit	Reinforced
1	#Tappo ispezione			<input type="checkbox"/>
5	#Con Interrutt. Merit n.a.		194KSP17000000	<input type="checkbox"/>
6	#Con Interrutt. TDS n.a.		194KSP28000000	<input type="checkbox"/>

OUTLET VERSIONS (ZZZ)

P17A6	Description
101	3-HOLE PUMP FRONT UNI
201	3-HOLE PUMP REAR UNI
501	FL SPICER 1120 REAR SIDE
503	FL SPICER 1300 REAR SIDE

511

FL DIN10 REAR SIDE

512

FL DIN00 REAR SIDE

INTERPOMPA
HYDRAULICS

Conversion kit

Pneumatic/Mechanic	DIN 5462 (SE) FROM UNI	606X01UNIZ0000
Mechanic/Pneumatic		
Electric control		

Flange kit

P17A6	Description
197KFL01000000	SPICER 1120 21UNI222
197KFL03000000	SPICER 1300 21UNI222
197KFL11000000	DIN10 21UNI222
197KFL12000000	DIN00 21UNI222

Lubrication kit

Switch kit

P17A6	Description
194KSP17000000	DIN 2.5 M16x1.5 N.O.
194KSP28000000	#TDS M16x1.5 N.O.

Bracket kit

P17A6	Description
190ST0018G0000	#Cavo I20 su serie 18
190ST0018T0000	#Cavo TXZ su serie 18

ELECTRIC KITS

P17A6	Description
194KE063000000	ELECTRIC KIT 12V FOR VACUUM PTO CONTROL
194KE064000000	ELECTRIC KIT 24V FOR VACUUM PTO CONTROL